

# Ball Valves

BV1-Floating Ball Valve, BV2-Trunnion Ball Valve, BVT-Throttling Ball Valve

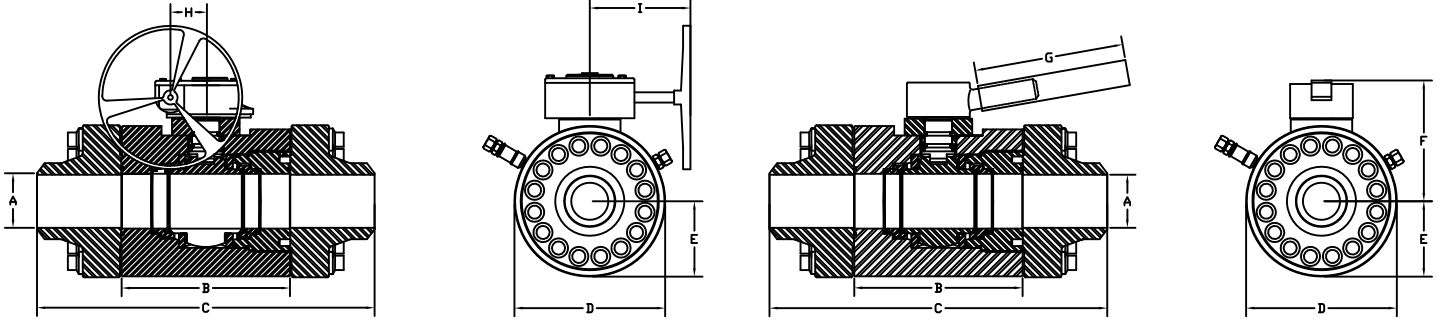

Working Pressure psi (bar)	Model	Nominal Valve Size in (mm)	Assembly Base No.	Std. End Configuration	Port Size in (mm)	Body Group Length in (mm)	Weld Ends Overall in (mm)	Body Width in (mm)	Below Center in (mm)	Height of Handle in (mm)	Length of Extension in (mm)	Offset from Center in (mm)	Hand Wheel from Center in (mm)
3705 (255)	BV1	1 (25)	129-	SLP x SLP	13/16 (21)	4 (102)	12 (305)	4 1/8 (105)	2 1/16 (52)	4 5/16 (110)	24 (610)	-	-
		2 (51)	116-	SLP x SLP	1 1/2 (38)	5 (127)	15 1/2 (394)	5 1/2 (140)	2 3/4 (70)	5 1/32 (128)	24 (610)	-	-
		3 (76)	123-	SLP x SLP	2 9/16 (65)	7 (178)	18 1/2 (470)	7 1/2 (191)	3 3/4 (95)	6 27/32 (174)	24 (610)	-	-
		4 (102)	124-	WNF x SLP	3 1/4 (83)	10 (254)	21 1/2 (546)	9 (229)	4 1/2 (114)	7 15/16 (202)	24 (610)	-	-
	BV2	3 (76)	222-	SLP x SLP	2 9/16 (65)	7 (178)	18 1/2 (470)	7 1/2 (191)	3 3/4 (95)	6 7/8 (175)	24 (610)	-	-
		4 (102)	223-	SLP x SLP	3 1/4 (83)	8 (203)	21 (533)	8 3/4 (222)	4 3/8 (111)	7 15/16 (202)	24 (610)	2.80 (71)	7.91 (201)
		4 (102)	225-	WNF x SLP	3 3/4 (95)	10 (254)	21 1/2 (546)	9 1/2 (241)	4 3/4 (121)	8 1/32 (204)	32 (813)	2.80 (71)	7.91 (201)
		6 (152)	226-	WNF x SLP	5 3/16 (132)	12 (305)	23 1/2 (597)	12 7/8 (327)	6 7/16 (164)	10 3/8 (264)	48 (1220)	3.39 (86)	7.44 (189)
		8 (203)	256-	WNF x SLP	7 1/16 (179)	15 (381)	29 (737)	16 1/2 (419)	8 1/4 (210)	-	-	5.12 (130)	10.83 (275)
		10 (254)	258-	WNF x WNF	9 1/16 (230)	18 (457)	33 (838)	20 (508)	10 (254)	-	-	5.12 (130)	10.83 (275)
BVT	2 (51)	816-	SLP x SLP	1 1/2 (38)	5 (127)	15 1/2 (394)	5 1/2 (140)	2 3/4 (70)	5 1/32 (128)	24 (610)	-	-	
5000 (344)	BV1	1 (25)	129-	SLP x SLP	13/16 (21)	4 (102)	12 (305)	4 1/8 (105)	2 1/16 (52)	4 5/16 (110)	24 (610)	-	-
		2 (51)	116-	SLP x SLP	1 1/2 (38)	5 (127)	15 1/2 (394)	5 1/2 (140)	2 3/4 (70)	5 1/32 (128)	24 (610)	-	-
		3 (76)	123-	SLP x SLP	2 9/16 (65)	7 (178)	18 1/2 (470)	7 1/2 (191)	3 3/4 (95)	6 27/32 (174)	24 (610)	-	-
		4 (102)	124-	WNF x SLP	3 1/4 (83)	10 (254)	21 1/2 (546)	9 (229)	4 1/2 (114)	7 15/16 (202)	24 (610)	-	-
	BV2	3 (76)	222-	SLP x SLP	2 9/16 (65)	7 (178)	18 1/2 (470)	7 1/2 (191)	3 3/4 (95)	6 7/8 (175)	24 (610)	-	-
		4 (102)	224-	WNF x SLP	3 1/4 (83)	10 (254)	21 1/2 (546)	9 (229)	4 1/2 (114)	7 15/16 (202)	8 5/32 (207)	3.39 (86)	7.44 (189)
		6 (152)	228-	WNF x SLP	4 3/4 (121)	13 (330)	26 (660)	13 (330)	6 1/2 (165)	-	-	3.39 (86)	7.44 (189)
		6 (152)	236-	WNF x SLP	5 3/16 (132)	13 (330)	26 (660)	12 7/8 (327)	6 7/16 (164)	-	-	3.39 (86)	7.44 (189)
		8 (203)	256-	WNF x SLP	7 1/16 (179)	15 (381)	29 (737)	16 1/2 (419)	8 1/4 (210)	-	-	5.12 (130)	10.83 (275)
		10 (254)	258-	WNF x WNF	9 1/16 (230)	18 (457)	33 (838)	20 (508)	10 (254)	-	-	5.12 (130)	10.83 (275)
BVT	2 (51)	816-	SLP x SLP	1 1/2 (38)	5 (127)	15 1/2 (394)	5 1/2 (140)	2 3/4 (70)	5 1/32 (128)	24 (610)	-	-	
6000 (413)	BV1	1 (25)	129-	SLP x SLP	13/16 (21)	4 (102)	12 (305)	4 1/8 (105)	2 1/16 (52)	4 5/16 (110)	24 (610)	-	-
		2 (51)	116-	SLP x SLP	1 1/2 (38)	5 (127)	15 1/2 (394)	5 1/2 (140)	2 3/4 (70)	5 1/32 (128)	24 (610)	-	-
		3 (76)	123-	SLP x SLP	2 9/16 (65)	7 (178)	18 1/2 (470)	7 1/2 (191)	3 3/4 (95)	6 27/32 (174)	24 (610)	-	-
		4 (102)	124-	WNF x SLP	3 1/4 (83)	10 (254)	21 1/2 (546)	9 (229)	4 1/2 (114)	7 15/16 (202)	24 (610)	-	-
	BV2	3 (76)	221-	SLP x SLP	2 1/4 (57)	7 (178)	18 1/2 (470)	7 1/2 (191)	3 3/4 (95)	6 13/16 (173)	24 (610)	-	-
		4 (102)	224-	WNF x SLP	3 1/4 (83)	10 (254)	21 1/2 (546)	9 (229)	4 1/2 (114)	7 15/16 (202)	8 5/32 (207)	3.39 (86)	7.44 (189)
		6 (152)	228-	WNF x SLP	4 3/4 (121)	13 (330)	26 (660)	13 (330)	6 1/2 (165)	-	-	3.39 (86)	7.44 (189)
		8 (203)	256-	WNF x SLP	7 1/16 (179)	15 (381)	29 (737)	16 1/2 (419)	8 1/4 (210)	-	-	5.12 (130)	10.83 (275)
		10 (254)	258-	WNF x WNF	9 1/16 (230)	18 (457)	33 (838)	20 (508)	10 (254)	-	-	5.12 (130)	10.83 (275)
		12 (305)	264-	WNF x WNF	9 3/4 (250)	20 (508)	37 (940)	22 1/2 (572)	11 1/4 (286)	-	-	-	-
BVT	2 (51)	816-	SLP x SLP	1 1/2 (38)	5 (127)	15 1/2 (394)	5 1/2 (140)	2 3/4 (70)	5 1/32 (128)	24 (610)	-	-	
10,000 (689)	BV1	1 (25)	129-	SLP x SLP	13/16 (21)	4 (102)	12 (305)	4 1/8 (105)	2 1/16 (52)	4 5/16 (110)	24 (610)	-	-
		2 (51)	130-	SLP x SLP	1 1/2 (38)	5 1/2 (140)	16 (406)	6 (152)	3 (76)	5 1/8 (130)	24 (610)	-	-
	BV2	3 (76)	233-	WNF x WNF	2 5/8 (67)	8 (203)	18 (457)	9 (229)	4 1/2 (114)	7 13/32 (190)	32 (813)	3.39 (86)	7.44 (189)
		4 (102)	234-	WNF x WNF	3 1/8 (79)	9 (229)	20 (508)	10 (254)	5 (127)	9 3/16 (233)	32 (813)	3.39 (86)	7.44 (189)
		6 (152)	235-	WNF x WNF	4 1/8 (105)	12 (305)	24 1/2 (622)	12 3/4 (324)	6 3/8 (162)	-	-	4.11 (104)	9.06 (230)
		6 (152)	366-	WNF x WNF	5.18 (132)	14 (356)	26 1/2 (673)	15 3/4 (400)	7 7/8 (200)	-	-	5.12 (130)	10.83 (275)
		8 (203)	261-	WNF x WNF	6.225 (158)	15 (381)	31 (787)	17 1/2 (445)	8 1/2 (216)	-	-	-	-
		10 (254)	262-	WNF x WNF	7 3/4 (197)	17 (432)	33 (838)	21 (533)	10 1/2 (267)	-	-	-	-
	BVT	2 (51)	830-	SLP x SLP	1 1/2 (38)	5 1/2 (140)	16 (406)	6 (152)	3 (76)	5 1/8 (130)	24 (610)	-	-
	15,000 (1,034)	BV2	1 (25)	137-	WNF x WNF	.60 (15)	4 3/4 (121)	10 3/4 (273)	4 3/8 (111)	2 3/16 (56)	4 11/32 (110)	24 (610)	-
2 (51)			238-	WNF x WNF	1 1/2 (38)	7 (178)	16 (406)	7.20 (183)	3.6 (91)	5.83 (148)	-	-	-
3 (76)			240-	WNF x WNF	1.9 (48)	9 (229)	18 (457)	9.90 (251)	4.95 (126)	-	-	-	-
4 (102)			242-	WNF x WNF	2.6 (66)	10 1/2 (267)	22 (559)	11.70 (297)	5.85 (149)	-	-	-	-
6 (152)			244-	WNF x WNF	3 5/8 (92)	11 1/2 (292)	24 (607)	14 3/4 (375)	7.38 (187)	-	-	5.12 (130)	10.83 (275)
8 (203)			246-	WNF x WNF	5 5/8 (134)	13 1/2 (343)	27 1/2 (699)	19.20 (488)	9.60 (244)	-	-	-	-
BVT	10 (254)	266-	WNF x WNF	7 3/4 (197)	17 (432)	33 (838)	21 (533)	10 1/2 (267)	-	-	-	-	



# Assembly Part Numbers for BV1 and BV2

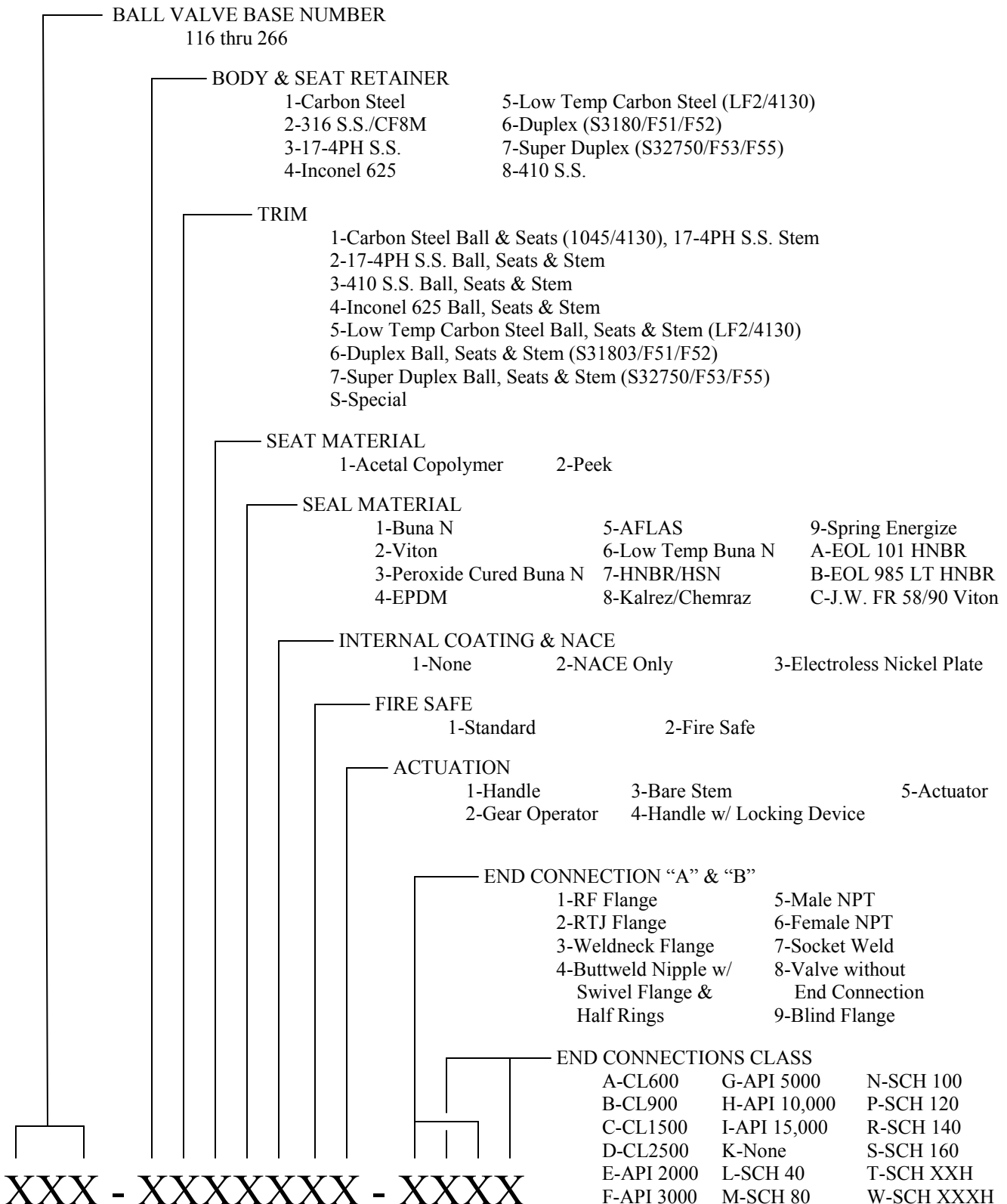

NOT SHOWN

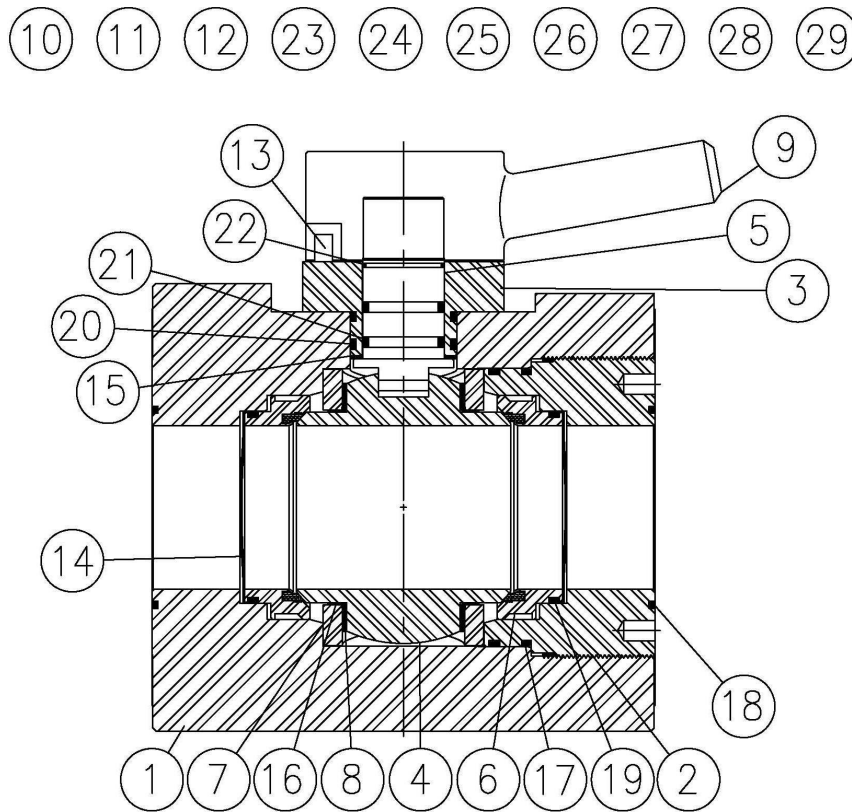

## BV2 COMMON COMPONET PARTS

INDEX	REQUIRED	DESCRIPTION	MATERIAL
1	1	Body	Carbon Steel or Alloy Steel
2	1	Seat Retainer	Carbon Steel or Alloy Steel
3	1	Bonnet	Carbon Steel
4	1	Trunnion Ball	Carbon Steel, Alloy Steel (ENP) or 17-4PH S.S.
5	1	Stem	17-4PH S.S.
6	2	Seat Assembly	Carbon Steel or 17-4PH S.S./Acetaly Copolymer or Peek
7	2	Trunnion Bearing Support	Carbon Steel
8	2	Trunnion Bearing	Garlock DU
9	1	Handle	Carbon Steel
10	1	Cap	Carbon Steel
11	1	Stem/Handle Key	Carbon Steel
12	1	Set Screw	Carbon Steel - Zinc Plated
13	1	Stop Pin	Carbon Steel
14	Varies	Wave Spring	Carbon Steel or Inconel X-750
15	1	Stem Thrust Bearing	Delrin
16	2	Trunnion Shim	Nylon
17	2	Seat Retainer Seal	Buna, Viton, Peroxide Cured Buna, EPDM, AFLAS, Low Temp Buna
18	2	Face Seal	Buna, Viton, Peroxide Cured Buna, EPDM, AFLAS, Low Temp Buna
19	4	Seat Assembly Seal	Buna, Viton, Peroxide Cured Buna, EPDM, AFLAS, Low Temp Buna
20	2	Bonnet Seal	Buna, Viton, Peroxide Cured Buna, EPDM, AFLAS, Low Temp Buna
21	2	Stem Seal	Buna, Viton, Peroxide Cured Buna, EPDM, AFLAS, Low Temp Buna
22	1	Stem Weather Seal	Buna, Viton, Peroxide Cured Buna, EPDM, AFLAS, Low Temp Buna
23	Varies	Cap Screw Weather Seal	Nylon
24	Varies	Bonnet Cap Screw	Alloy Steel
25	1	Body Lubrication Fitting	Carbon Steel - Zinc Plated or 316 S.S.
26	1	Stem Lubrication Fitting	Carbon Steel - Zinc Plated
27	1	Body Vent/Bleeder Fitting	Carbon Steel - Zinc Plated or 316 S.S.
28	1	End Connection Assembly-"A" End	Carbon Steel or Alloy Steel, B7 Bolting
29	1	End Connection Assembly-"B" End	Carbon Steel or Alloy Steel, B7 Bolting



# Assembly Part Numbers for BV2 Repair Kit

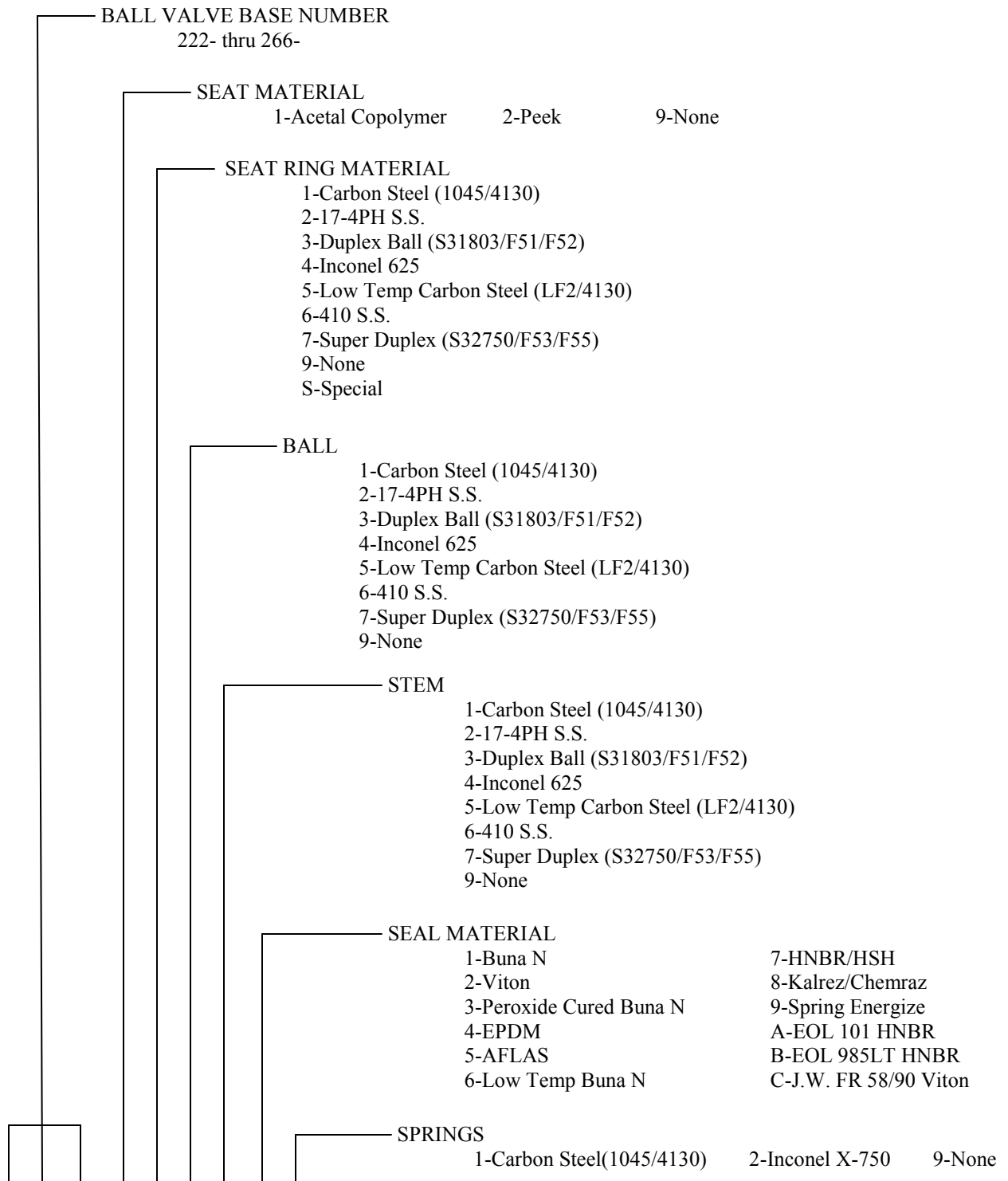

**BV2 - XXX XXXXXXX**

