

Ball Valves

BV1-Floating Ball Valve, BV2-Trunnion Ball Valve, BVT-Throttling Ball Valve

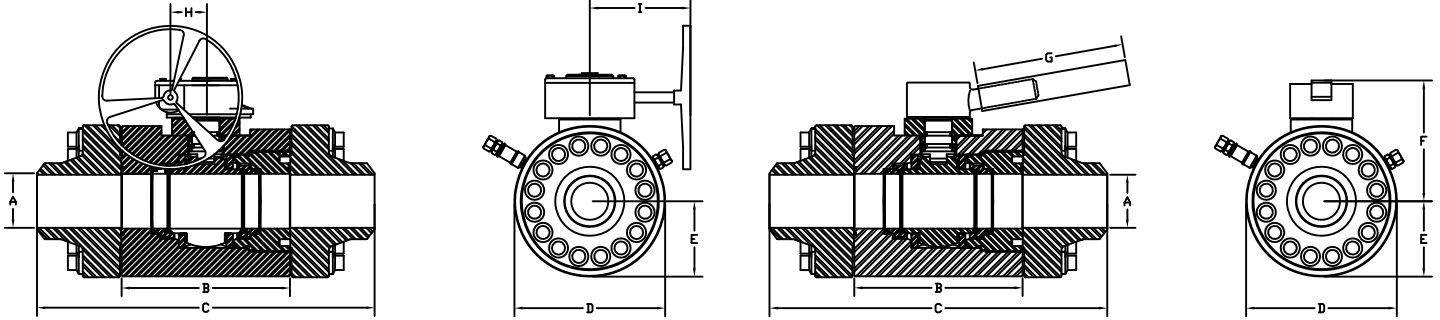

Working Pressure psi (bar)	Model	Nominal Valve Size in (mm)	Assembly Base No.	Std. End Configuration	Port Size in (mm)	Body Group Length in (mm)	Weld Ends Overall in (mm)	Body Width in (mm)	Below Center in (mm)	Height of Handle in (mm)	Length of Extension in (mm)	Offset from Center in (mm)	Hand Wheel from Center in (mm)
3705 (255)	BV1	1 (25)	129-	SLP x SLP	13/16 (21)	4 (102)	12 (305)	4 1/8 (105)	2 1/16 (52)	4 5/16 (110)	24 (610)	-	-
		2 (51)	116-	SLP x SLP	1 1/2 (38)	5 (127)	15 1/2 (394)	5 1/2 (140)	2 3/4 (70)	5 1/32 (128)	24 (610)	-	-
		3 (76)	123-	SLP x SLP	2 9/16 (65)	7 (178)	18 1/2 (470)	7 1/2 (191)	3 3/4 (95)	6 27/32 (174)	24 (610)	-	-
		4 (102)	124-	WNF x SLP	3 1/4 (83)	10 (254)	21 1/2 (546)	9 (229)	4 1/2 (114)	7 15/16 (202)	24 (610)	-	-
	BV2	3 (76)	222-	SLP x SLP	2 9/16 (65)	7 (178)	18 1/2 (470)	7 1/2 (191)	3 3/4 (95)	6 7/8 (175)	24 (610)	-	-
		4 (102)	223-	SLP x SLP	3 1/4 (83)	8 (203)	21 (533)	8 3/4 (222)	4 3/8 (111)	7 15/16 (202)	24 (610)	2.80 (71)	7.91 (201)
		4 (102)	225-	WNF x SLP	3 3/4 (95)	10 (254)	21 1/2 (546)	9 1/2 (241)	4 3/4 (121)	8 1/32 (204)	32 (813)	2.80 (71)	7.91 (201)
		6 (152)	226-	WNF x SLP	5 3/16 (132)	12 (305)	23 1/2 (597)	12 7/8 (327)	6 7/16 (164)	10 3/8 (264)	48 (1220)	3.39 (86)	7.44 (189)
		8 (203)	256-	WNF x SLP	7 1/16 (179)	15 (381)	29 (737)	16 1/2 (419)	8 1/4 (210)	-	-	5.12 (130)	10.83 (275)
		10 (254)	258-	WNF x WNF	9 1/16 (230)	18 (457)	33 (838)	20 (508)	10 (254)	-	-	5.12 (130)	10.83 (275)
BVT	2 (51)	816-	SLP x SLP	1 1/2 (38)	5 (127)	15 1/2 (394)	5 1/2 (140)	2 3/4 (70)	5 1/32 (128)	24 (610)	-	-	
5000 (344)	BV1	1 (25)	129-	SLP x SLP	13/16 (21)	4 (102)	12 (305)	4 1/8 (105)	2 1/16 (52)	4 5/16 (110)	24 (610)	-	-
		2 (51)	116-	SLP x SLP	1 1/2 (38)	5 (127)	15 1/2 (394)	5 1/2 (140)	2 3/4 (70)	5 1/32 (128)	24 (610)	-	-
		3 (76)	123-	SLP x SLP	2 9/16 (65)	7 (178)	18 1/2 (470)	7 1/2 (191)	3 3/4 (95)	6 27/32 (174)	24 (610)	-	-
		4 (102)	124-	WNF x SLP	3 1/4 (83)	10 (254)	21 1/2 (546)	9 (229)	4 1/2 (114)	7 15/16 (202)	24 (610)	-	-
	BV2	3 (76)	222-	SLP x SLP	2 9/16 (65)	7 (178)	18 1/2 (470)	7 1/2 (191)	3 3/4 (95)	6 7/8 (175)	24 (610)	-	-
		4 (102)	224-	WNF x SLP	3 1/4 (83)	10 (254)	21 1/2 (546)	9 (229)	4 1/2 (114)	7 15/16 (202)	8 5/32 (207)	3.39 (86)	7.44 (189)
		6 (152)	228-	WNF x SLP	4 3/4 (121)	13 (330)	26 (660)	13 (330)	6 1/2 (165)	-	-	3.39 (86)	7.44 (189)
		6 (152)	236-	WNF x SLP	5 3/16 (132)	13 (330)	26 (660)	12 7/8 (327)	6 7/16 (164)	-	-	3.39 (86)	7.44 (189)
		8 (203)	256-	WNF x SLP	7 1/16 (179)	15 (381)	29 (737)	16 1/2 (419)	8 1/4 (210)	-	-	5.12 (130)	10.83 (275)
		10 (254)	258-	WNF x WNF	9 1/16 (230)	18 (457)	33 (838)	20 (508)	10 (254)	-	-	5.12 (130)	10.83 (275)
BVT	2 (51)	816-	SLP x SLP	1 1/2 (38)	5 (127)	15 1/2 (394)	5 1/2 (140)	2 3/4 (70)	5 1/32 (128)	24 (610)	-	-	
6000 (413)	BV1	1 (25)	129-	SLP x SLP	13/16 (21)	4 (102)	12 (305)	4 1/8 (105)	2 1/16 (52)	4 5/16 (110)	24 (610)	-	-
		2 (51)	116-	SLP x SLP	1 1/2 (38)	5 (127)	15 1/2 (394)	5 1/2 (140)	2 3/4 (70)	5 1/32 (128)	24 (610)	-	-
		3 (76)	123-	SLP x SLP	2 9/16 (65)	7 (178)	18 1/2 (470)	7 1/2 (191)	3 3/4 (95)	6 27/32 (174)	24 (610)	-	-
		4 (102)	124-	WNF x SLP	3 1/4 (83)	10 (254)	21 1/2 (546)	9 (229)	4 1/2 (114)	7 15/16 (202)	24 (610)	-	-
	BV2	3 (76)	221-	SLP x SLP	2 1/4 (57)	7 (178)	18 1/2 (470)	7 1/2 (191)	3 3/4 (95)	6 13/16 (173)	24 (610)	-	-
		4 (102)	224-	WNF x SLP	3 1/4 (83)	10 (254)	21 1/2 (546)	9 (229)	4 1/2 (114)	7 15/16 (202)	8 5/32 (207)	3.39 (86)	7.44 (189)
		6 (152)	228-	WNF x SLP	4 3/4 (121)	13 (330)	26 (660)	13 (330)	6 1/2 (165)	-	-	3.39 (86)	7.44 (189)
		8 (203)	256-	WNF x SLP	7 1/16 (179)	15 (381)	29 (737)	16 1/2 (419)	8 1/4 (210)	-	-	5.12 (130)	10.83 (275)
		10 (254)	258-	WNF x WNF	9 1/16 (230)	18 (457)	33 (838)	20 (508)	10 (254)	-	-	5.12 (130)	10.83 (275)
		12 (305)	264-	WNF x WNF	9 3/4 (250)	20 (508)	37 (940)	22 1/2 (572)	11 1/4 (286)	-	-	-	-
BVT	2 (51)	816-	SLP x SLP	1 1/2 (38)	5 (127)	15 1/2 (394)	5 1/2 (140)	2 3/4 (70)	5 1/32 (128)	24 (610)	-	-	
10,000 (689)	BV1	1 (25)	129-	SLP x SLP	13/16 (21)	4 (102)	12 (305)	4 1/8 (105)	2 1/16 (52)	4 5/16 (110)	24 (610)	-	-
		2 (51)	130-	SLP x SLP	1 1/2 (38)	5 1/2 (140)	16 (406)	6 (152)	3 (76)	5 1/8 (130)	24 (610)	-	-
	BV2	3 (76)	233-	WNF x WNF	2 5/8 (67)	8 (203)	18 (457)	9 (229)	4 1/2 (114)	7 13/32 (190)	32 (813)	3.39 (86)	7.44 (189)
		4 (102)	234-	WNF x WNF	3 1/8 (79)	9 (229)	20 (508)	10 (254)	5 (127)	9 3/16 (233)	32 (813)	3.39 (86)	7.44 (189)
		6 (152)	235-	WNF x WNF	4 1/8 (105)	12 (305)	24 1/2 (622)	12 3/4 (324)	6 3/8 (162)	-	-	4.11 (104)	9.06 (230)
		6 (152)	366-	WNF x WNF	5.18 (132)	14 (356)	26 1/2 (673)	15 3/4 (400)	7 7/8 (200)	-	-	5.12 (130)	10.83 (275)
		8 (203)	261-	WNF x WNF	6.225 (158)	15 (381)	31 (787)	17 1/2 (445)	8 1/2 (216)	-	-	-	-
		10 (254)	262-	WNF x WNF	7 3/4 (197)	17 (432)	33 (838)	21 (533)	10 1/2 (267)	-	-	-	-
	BVT	2 (51)	830-	SLP x SLP	1 1/2 (38)	5 1/2 (140)	16 (406)	6 (152)	3 (76)	5 1/8 (130)	24 (610)	-	-
	15,000 (1,034)	BV2	1 (25)	137-	WNF x WNF	.60 (15)	4 3/4 (121)	10 3/4 (273)	4 3/8 (111)	2 3/16 (56)	4 11/32 (110)	24 (610)	-
2 (51)			238-	WNF x WNF	1 1/2 (38)	7 (178)	16 (406)	7.20 (183)	3.6 (91)	5.83 (148)	-	-	-
3 (76)			240-	WNF x WNF	1.9 (48)	9 (229)	18 (457)	9.90 (251)	4.95 (126)	-	-	-	-
4 (102)			242-	WNF x WNF	2.6 (66)	10 1/2 (267)	22 (559)	11.70 (297)	5.85 (149)	-	-	-	-
6 (152)			244-	WNF x WNF	3 5/8 (92)	11 1/2 (292)	24 (607)	14 3/4 (375)	7.38 (187)	-	-	5.12 (130)	10.83 (275)
8 (203)			246-	WNF x WNF	5 5/8 (134)	13 1/2 (343)	27 1/2 (699)	19.20 (488)	9.60 (244)	-	-	-	-
BVT	10 (254)	266-	WNF x WNF	7 3/4 (197)	17 (432)	33 (838)	21 (533)	10 1/2 (267)	-	-	-	-	



Assembly Part Numbers for BV1 and BV2

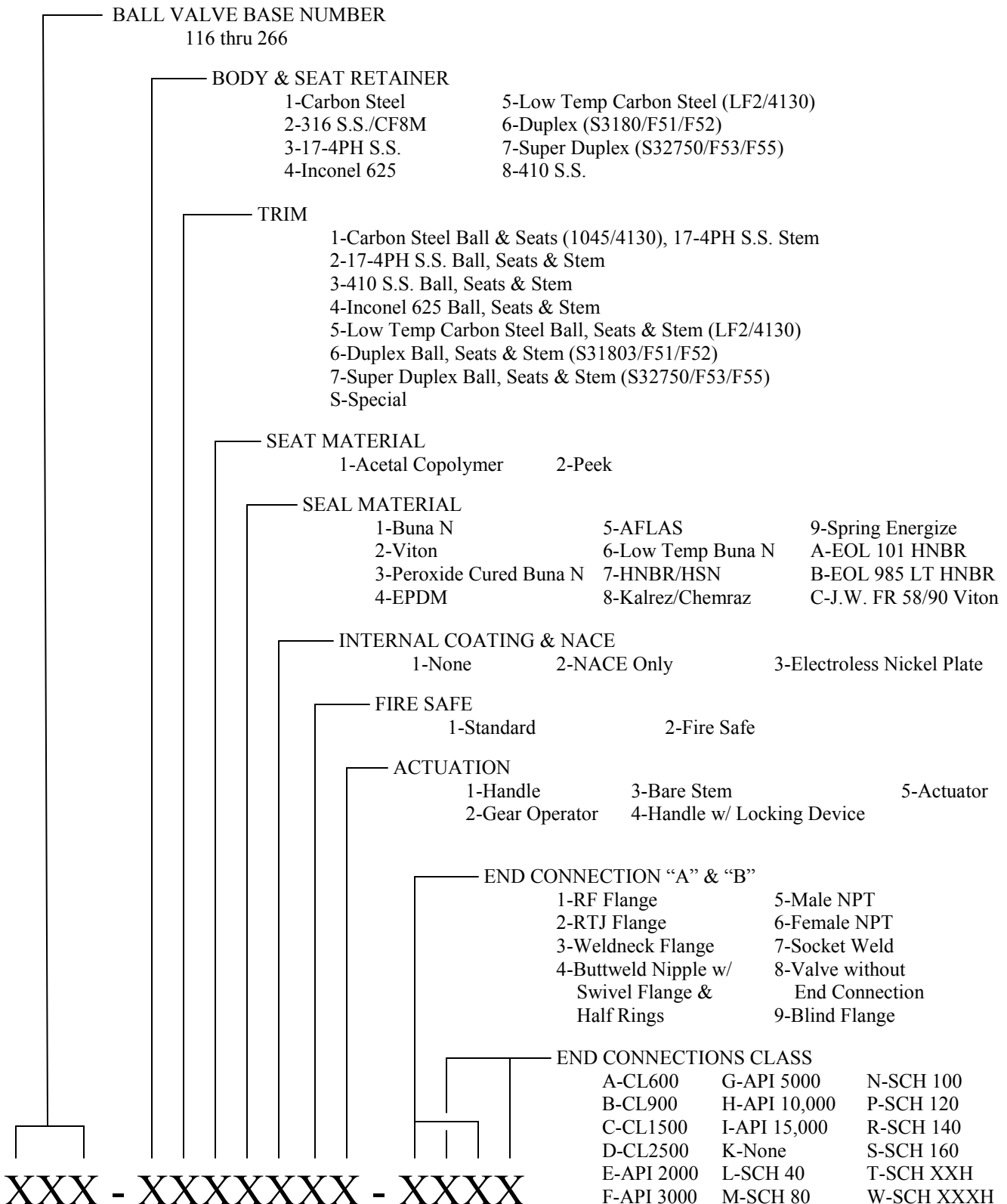

NOT SHOWN

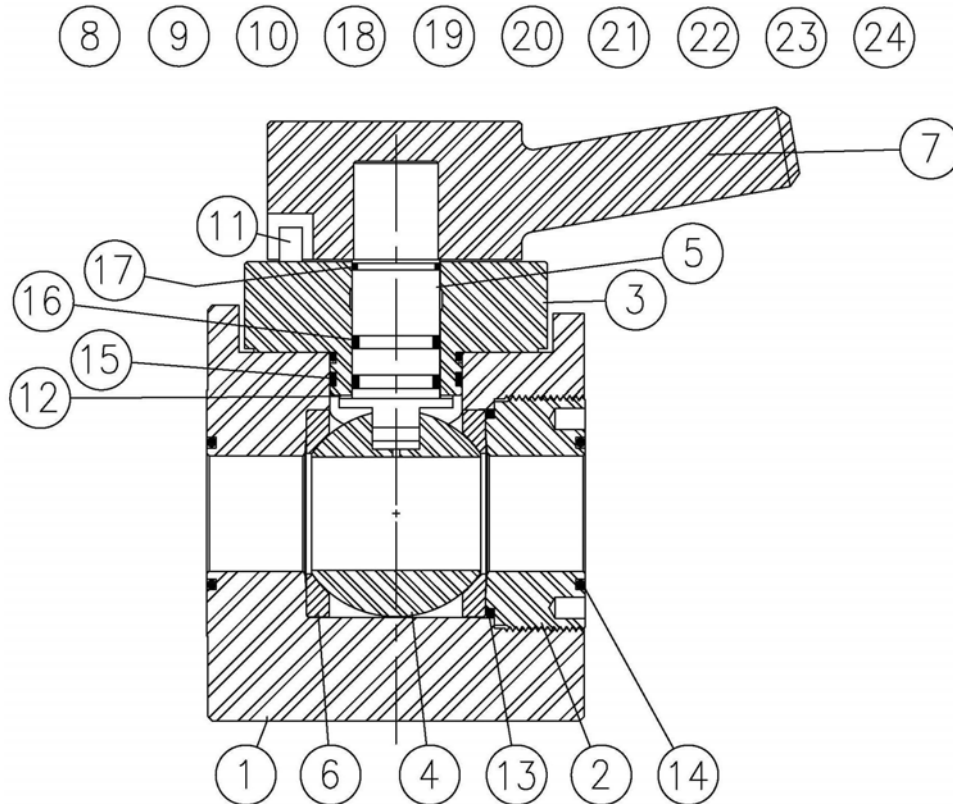

BV1 COMMON COMPONENT PARTS

INDEX	REQUIRED	DESCRIPTION	MATERIAL
1	1	Body	Carbon Steel or Alloy Steel
2	1	Seat Retainer	Carbon Steel or Alloy Steel
3	1	Bonnet	Carbon Steel
4	1	Floating Ball	Carbon Steel, Alloy Steel (ENP) or 17-4PH S.S.
5	1	Stem	17-4PH S.S.
6	2	Seat	Acetal Copolymer or Peek
7	1	Handle	Carbon Steel
8	1	Cap	Carbon Steel
9	1	Stem/Handle Key	Carbon Steel
10	1	Set Screw	Carbon Steel - Zinc Plated
11	1	Stop Pin	Carbon Steel
12	1	Stem Thrust Bearing	Delrin
13	2	Seat Retainer Seal	Buna, Viton, Peroxide Cured Buna, EPDM, AFLAS, Low Temp Buna
14	2	Face Seal	Buna, Viton, Peroxide Cured Buna, EPDM, AFLAS, Low Temp Buna
15	2	Bonnet Seal	Buna, Viton, Peroxide Cured Buna, EPDM, AFLAS, Low Temp Buna
16	2	Stem Seal	Buna, Viton, Peroxide Cured Buna, EPDM, AFLAS, Low Temp Buna
17	1	Stem Weather Seal	Buna, Viton, Peroxide Cured Buna, EPDM, AFLAS, Low Temp Buna
18	Varies	Cap Screw Weather Seal	Nylon
19	Varies	Bonnet Cap Screw	Alloy Steel
20	1	Body Lubrication Fitting	Carbon Steel - Zinc Plated or 316 S.S.
21	1	Stem Lubrication Fitting	Carbon Steel - Zinc Plated
22	1	Body Vent/Bleeder Fitting	Carbon Steel - Zinc Plated or 316 S.S.
23	1	End Connection Assembly-"A" End	Carbon Steel or Alloy Steel, B7 Bolting
24	1	End Connection Assembly-"B" End	Carbon Steel or Alloy Steel, B7 Bolting



Assembly Part Numbers for BV1 Repair Kit

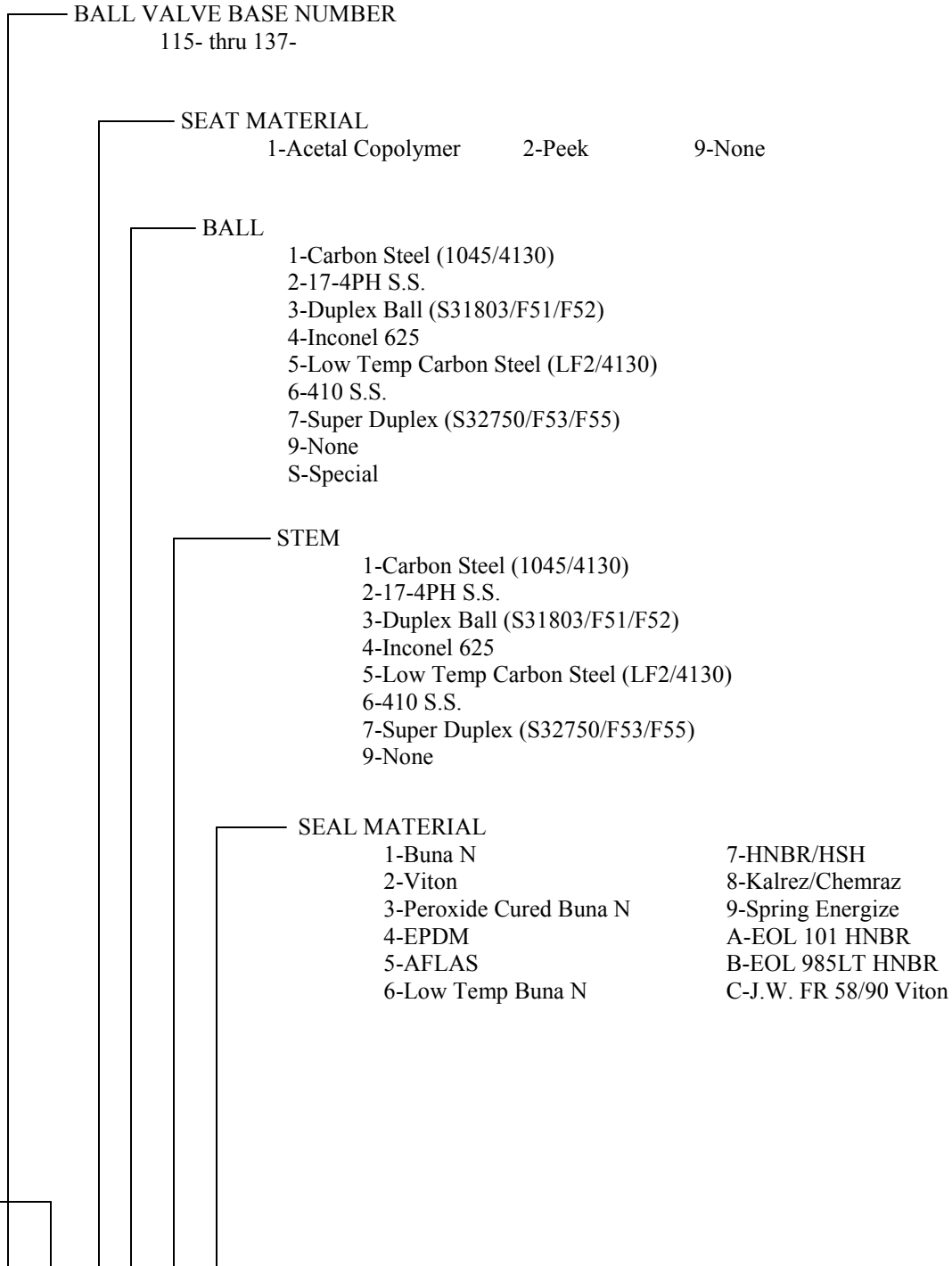

BV1 - XXX XXXX